

GE-320 series of armature brackets, embedded in a magnet, work with the electromagnets equipped with a door-position reed sensor (DS series). The brackets are advised to be installed with the assistance of a mushroom-head screw on wooden and hollow metal doors, but not fire doors.

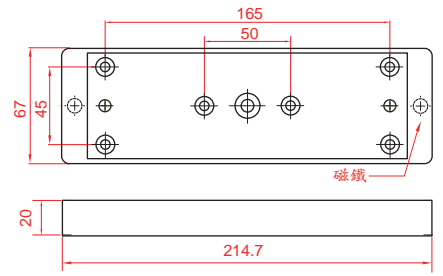

Application: Illustrated by GE-320L-DS

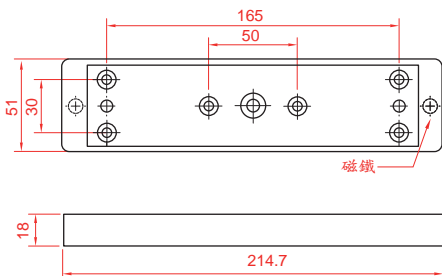
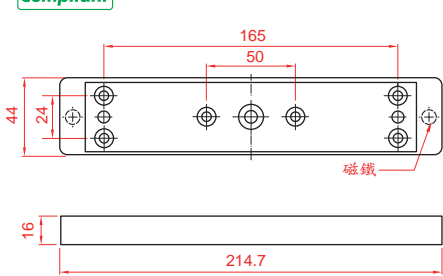
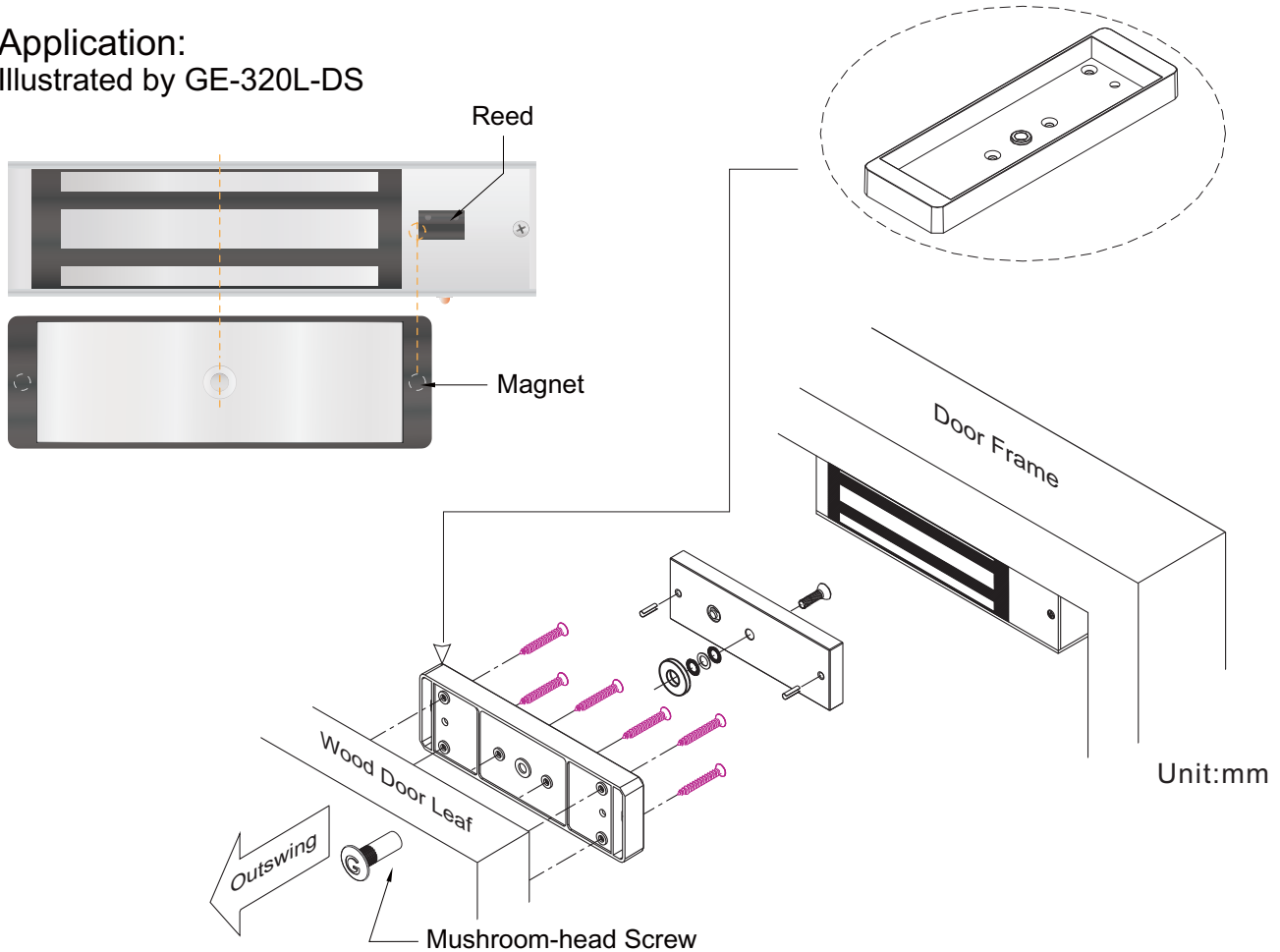

GIANNI INDUSTRIES, INC.