



EB261/EB265 electric dropbolt incorporates a mechanical cylinder to lock or unlock the door manually in case of an unexpected power failure.

### ● Features

- **Electric and mechanical operation via Euro-profile cylinder**
- **Bevel latchbolt resolving positioning problem**
- **Reversible latchbolt**
- **Fail-secure mode**



### ● Specification

- Fail-Secure Version (Power to Unlock)
- Operating Voltage: 12~24VAC/DC(self-regulating)
- Current Draw: 1A/12VDC (at 20°C)
- Operating Temperature: -10~+45°C
- Lock's surface Temperature (when the power is on): ambient temperature +20°C
- Tested over 500000 cycles.
- Face Plate Material: stainless steel
- Net Weight: 894g
- Locked and unlocked status output (EM261M/EB265M)

### ● Dimensions

Unit: mm

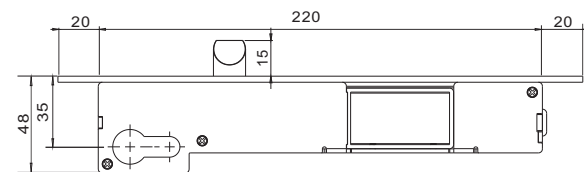
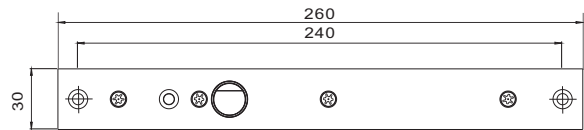
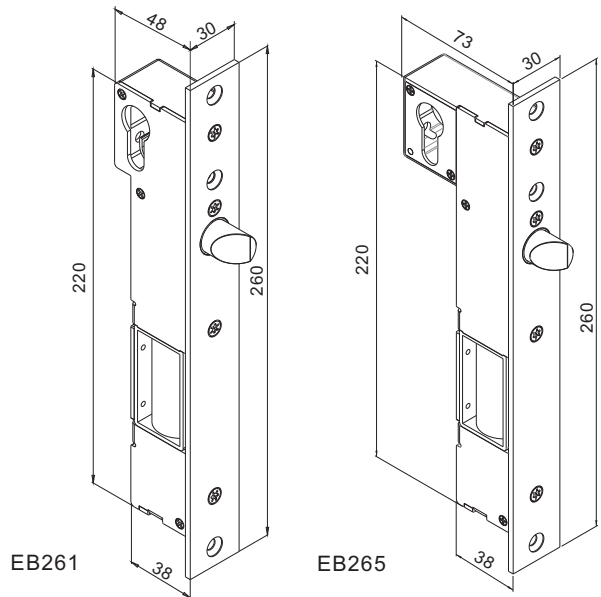

EB261

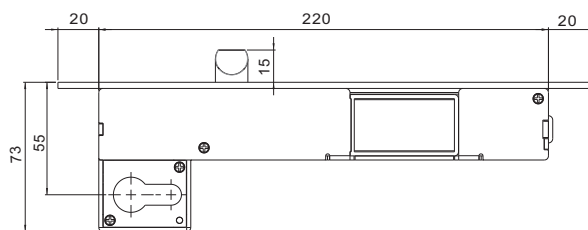
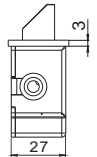

73

EB265

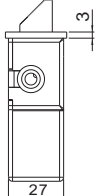

### GIANNI INDUSTRIES, INC.

### ● Door Leaf Flush Installation

EB261/EB265 can be fitted to the side of the door.

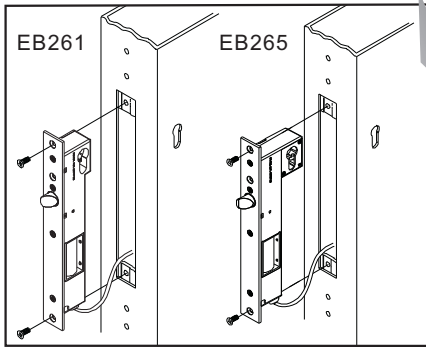
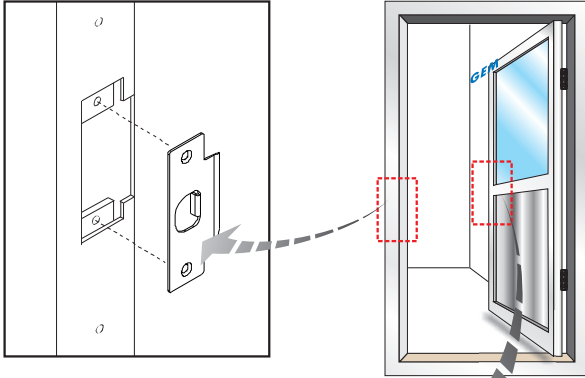

Cylinder is operated by thumb turn indoors or a key from outdoors.

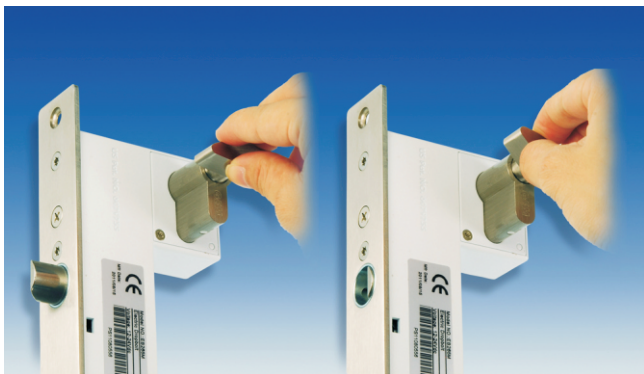

Illustration of manually unlocking the door with an EURO-profile cylinder (cylinder excluded)

### ● Optional Accessory

Single side cylinder or both side cylinder .



**ECY-72S**  
(Single Side Cylinder)



**ECY-72D**  
(Both Side Cylinder)

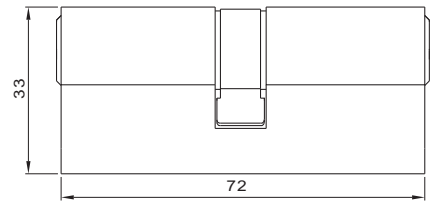
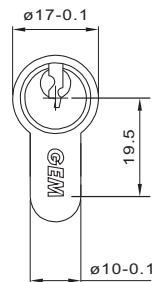

(Maximum door-leaf depth of 52 mm)

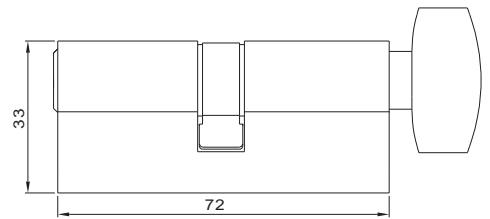
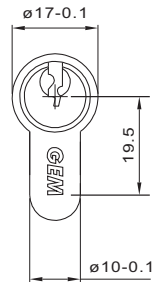

(Maximum door-leaf depth of 52 mm)

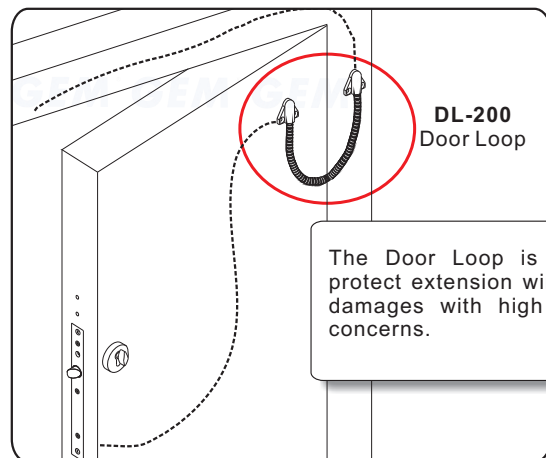

**DL-200**  
Door Loop

The Door Loop is used to protect extension wiring from damages with high security concerns.

### ● Adjustable Latch bolt

Please reverse the latch bolt according to the door opening direction.

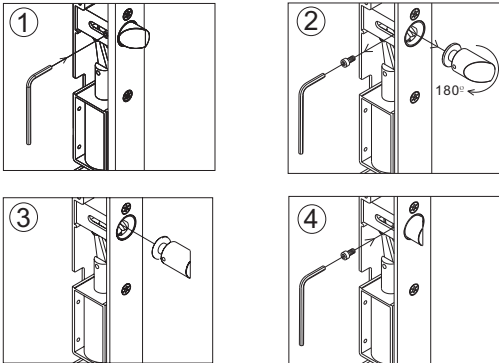

### ● 12~ 24VAC/DC self-regulating

The Electric Dropbolt operates on 12 ~ 24 VAC/DC input voltage with self regulating feature.

### ● Long Life Solenoids

The specially designed solenoid aims for strength and long life. The solenoid guarantees 500,000 times of operations.

### ● Single Action Doors

EB261/EB265 electric dropbolt is not designed for double swing doors. It can only be installed on both outswing and inswing doors.

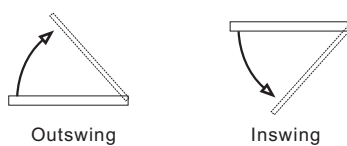

### ● Warranty

The product is warranted against defects in material and workmanship while used in normal service for a period of 1 year from the date of sale to the original customer. The GEM policy is one of continual development and improvement; therefore GEM reserves the right to change specifications without notice.

### **GIANNI INDUSTRIES, INC.**