

Features

- High reliability
- Dual voltage 12 or 24 VDC (selectable)
- MOV provides spike and surge protection
- Anti-Residual magnetism function
- Holding force up to 800 lbs

Statement

GL850 is designed for face mount on in-swing doors or gate. With stainless steel housing, it is suitable for outdoor applications and severe weather conditions. GL850M comes with magnetic bond sensor indicating locked and unlocked status.

Specification

- Operating Voltage: Single Voltage: 12 or 24VDC
Dual Voltage: 12/24VDC
- Current Draw:
Single Voltage: 340mA/12VDC, 250mA/24VDC
Dual Voltage: 500mA/12VDC, 250mA/24VDC
(at temperature 20°C)
- Bond sensor output (GL-850M): SPDT rated 0.5A/20VDC
- Operating Temperature: -10~55°C (14~131°F)
- Humidity: 0~95% non-condensing.
- Holding Force: Up to 800 lbs (363 Kg)
- Dimensions:
Magnet: (L) 232, (W) 45, (D) 30 mm
Armature Plate: (L) 185, (W) 45, (D) 14 mm
- Special Finishes for magnet and armature plate: Zinc plated
- Epoxy Potting Compound: E87252 (S), UL94V-0
- Net Weight : 2.6 Kg

Warranty

The product is warranted against defects in material and workmanship while used in normal service for a period of 5 year from the date of sale to the original customer. The GEM policy is one of continual development and improvement; therefore GEM reserves the right to change specifications without notice.

Regular Installation

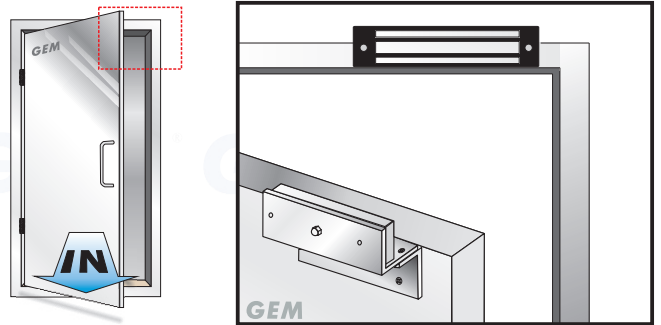

Optional Brackets

Z-bracket for inswing doors



Z-300N

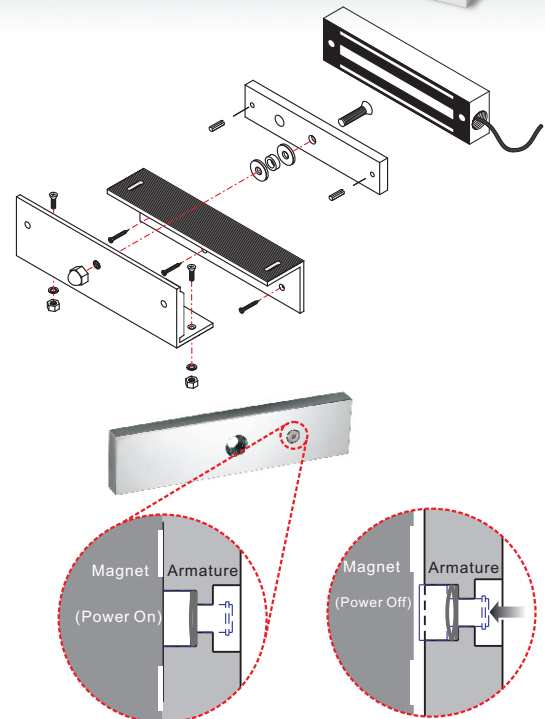

Anti-residual statement

Our electromagnet locks feature Anti-Residual Magnetism (ARM) which ensures the door can be opened without any resistance from left over magnetism imparted to the armature plate

GIANNI INDUSTRIES, INC.