

ML-210N-SW

Electric Lock Installation Instruction

Specifications

- Operating Voltage: 12~24VDC/AC
- Voltage Tolerance: $\pm 10\%$
- Current Draw: 250mA/12VDC; 150mA/24VDC
- Version Changeable: Fail-safe or Fail-secure
- Operating Temperature: 14°F to 120°F (-10°C~+49°C)
- Humidity: 0~85% non-condensing
- Lock bolt sensor switch output (For ML-210N-SW): SPDT rated 3A/125VAC
- Solenoid testing: Tested up to 1,000,000 cycles
- Net Weight: 594g
- Applicable to horizontal and vertical installation
- VGL bracket can be adjusted depending on the door gap ranging from 8 mm to 12 mm.

Double Swing Doors

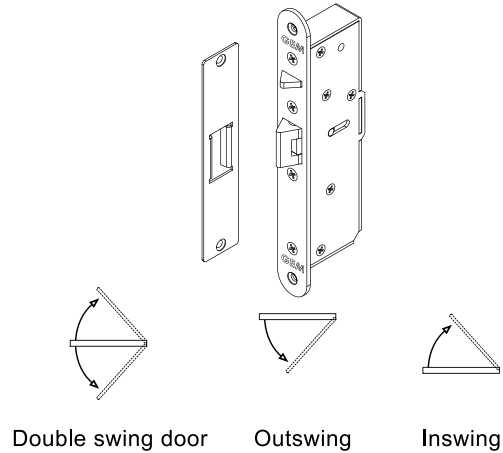

Installation Instructions

Unit:mm

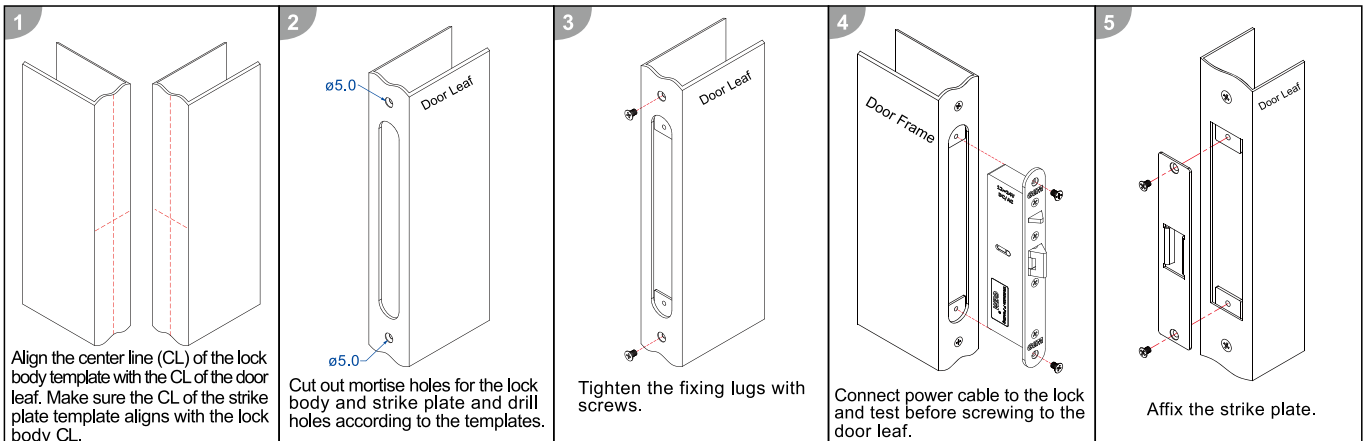
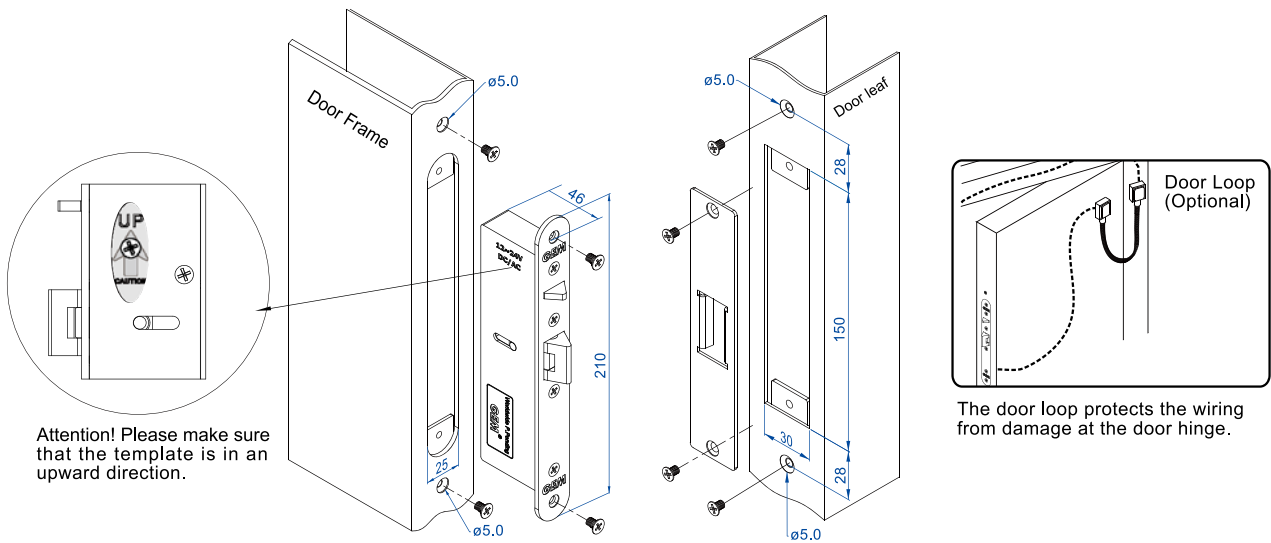

Installation Diagram

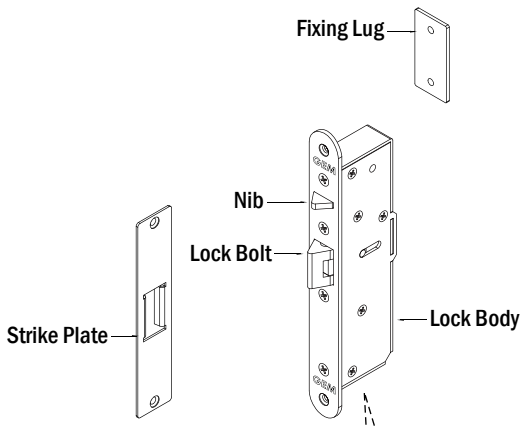

Version Changeable:

Take out the Screw 1, loosen the screw 2, move the position and then tighten both screws.

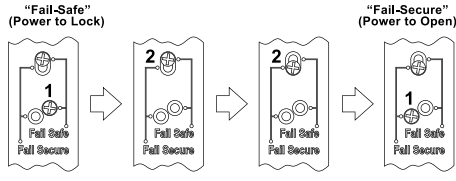

⚠ Caution:

Do not completely loosen screw 2 (as shown in the figure) as the interior solenoid might fall off.

Template

Unit:mm

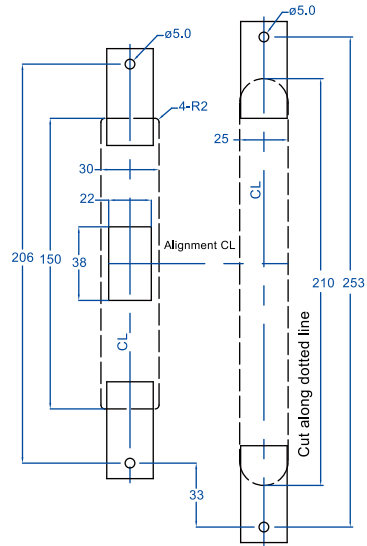

Butt Splice (IDC) Connector

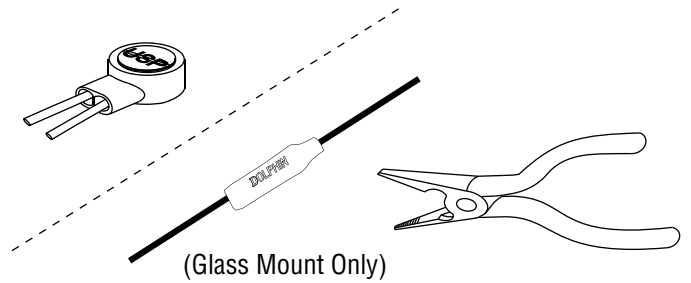

Use crimpers or pliers and press the header of connector down to even position.

Wiring Diagram

Optional Lock Bolt Sensor (LBS) Status Output:

With LBS output: ML-210N-SW

Without LBS output: ML-211-SW

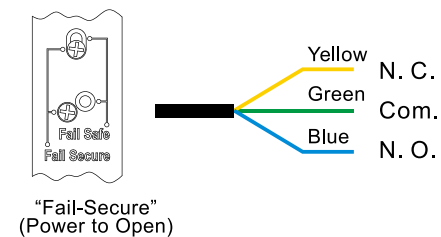
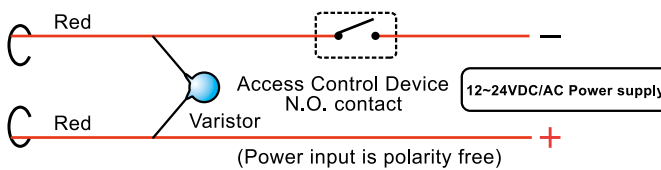
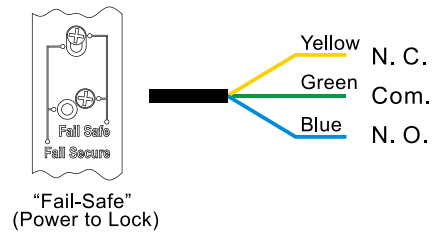
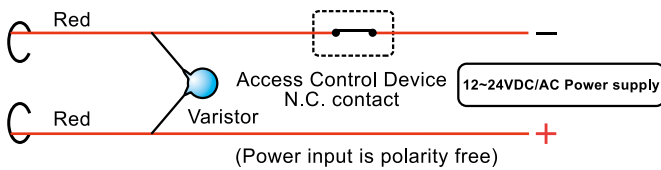

NOTE: The varistor (or diode) must be connected across the terminals of electric locks. This protects the electromechanical locks from spikes and surges.

Dimensions (Glass Mount & Surface Mount)

Unit:mm

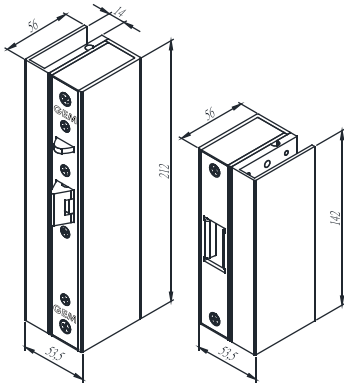

Lock Model:
ML-210N-SW-VGL (Monitored)
ML-211-SW-VGL (Non-Monitored)
(Including SMB-210 and UBK-210)

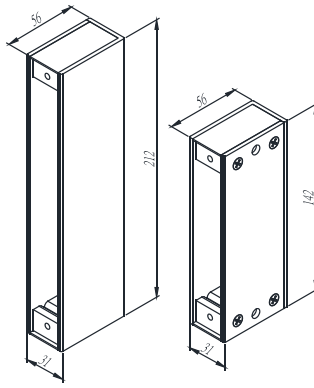

Bracket Model : SMB-210
(For Surface Mount)

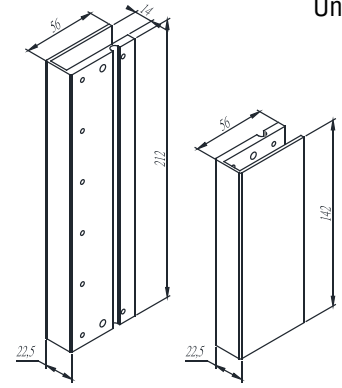

Bracket Model : UBK-210
(For Glass Mount)

Surface Mount Installation

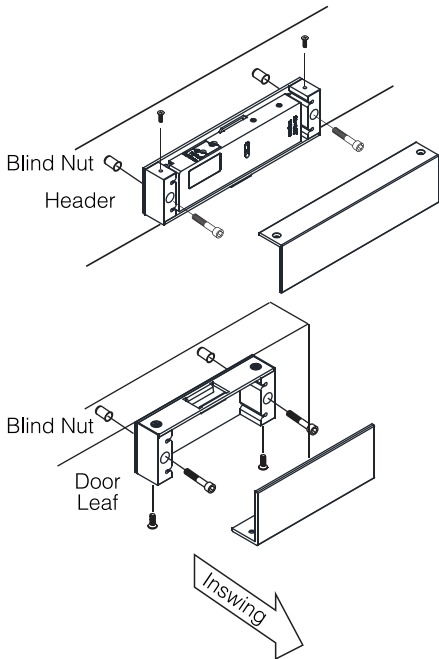

Installing Blind Nuts

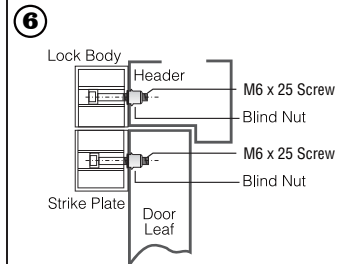
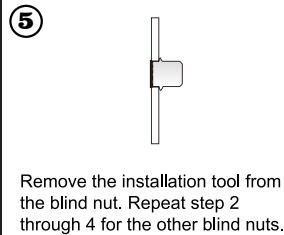
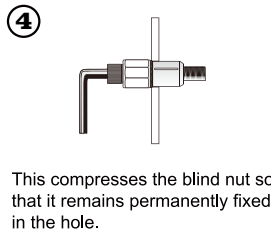
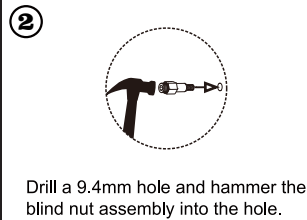
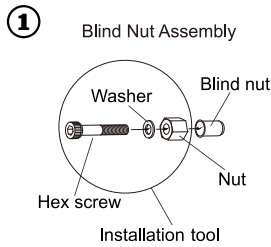

Glass Mount Installation

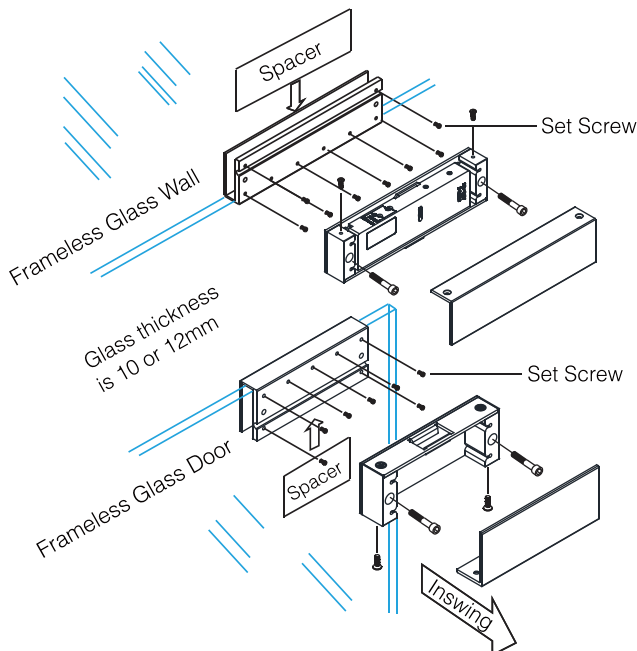

Installation Instructions

1. Make sure the installation location and clean the surface of glass.
2. Take off the sticker on the back of the spacer and attach the spacer to glass. Add more spacers if needed according to glass thickness. Use silicon to secure the VGL bracket firmly.
3. Tighten the set screws with the Allen wrench, secure the electromechanical lock to the glass bracket, and then install the cover.

Caution:

1. It is suggested to attach the spacer to inside of the door.
2. Tighten the set screws lightly to prevent breaking the glass.
- *3. NIB must be close to the door edge during installation.*
4. The glass thickness should be 10~13 mm. The bracket can be adjusted to properly align the position of strike plate and lock body depending on the door gap ranging from 8 to 12 mm.

